





401 W. 7th Street

AT MCRAE & LACY



-  3 Bedrooms
-  3.5 Bathrooms
-  3100 Square Feet
-  2 Car Garage

\$949,000



This Southaven is a 4-story end unit second floor entry townhome. On the first floor you will find your 2-car rear load garage, as well a rec room and full bath. You can take your personal elevator to any floor you choose, but first head on up to the second floor where you will find the main entry door to your home, along with your kitchen that has a large island opening right to the spacious family room with fireplace. A dining room completes the floor. The third floor has is an entire owner's suite with large primary bathroom and huge walk-in closet and laundry room! The fourth floor will have an additional bedroom and full bath, as well as a spacious media room that leads out to a large outdoor terrace. Enjoy beautiful views of the city and river from your terrace while sipping on your morning coffee or enjoying some evening appetizers and the sunset.

Features of this Home

- End unit
- Third floor entire owner's suite with bench seat in primary shower
- Elevator
- Fireplace in family room
- Fourth floor media room and large rear terrace
- Quartz waterfall countertops in kitchen

eagleofva.com

FIRST FLOOR

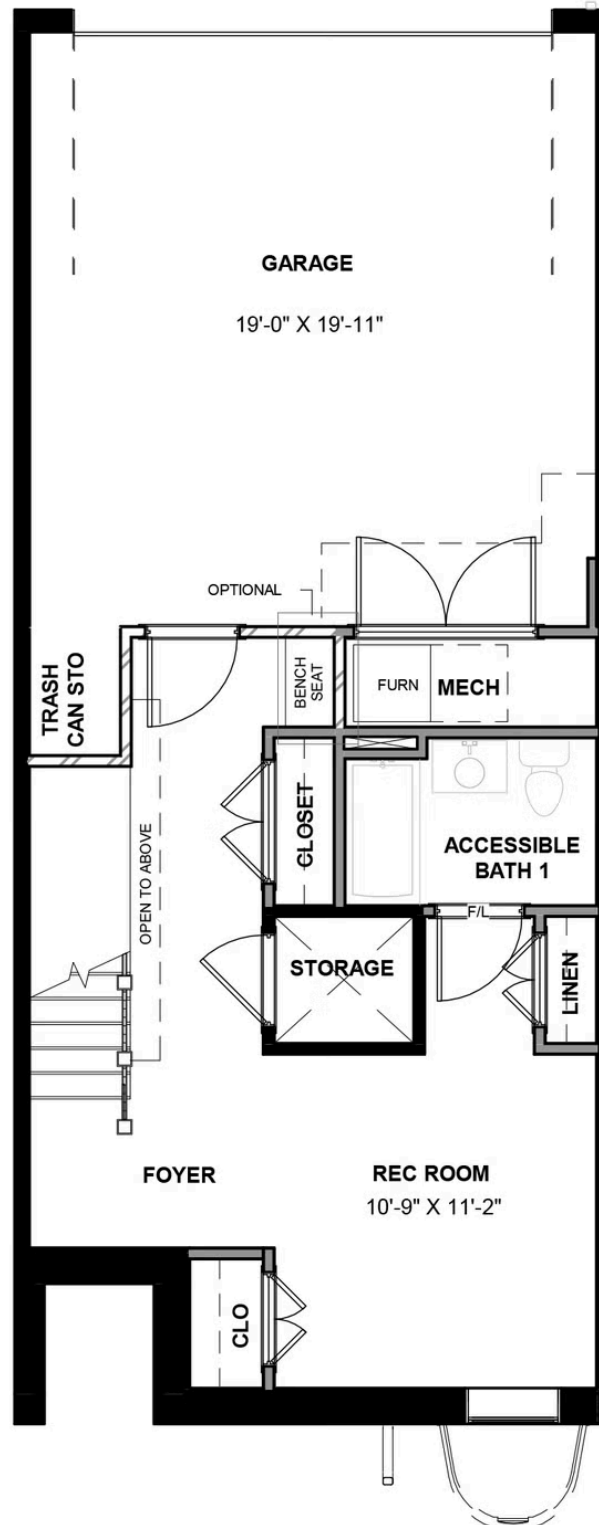

SECOND FLOOR



401 W. 7th Street

AT MCRAE & LACY

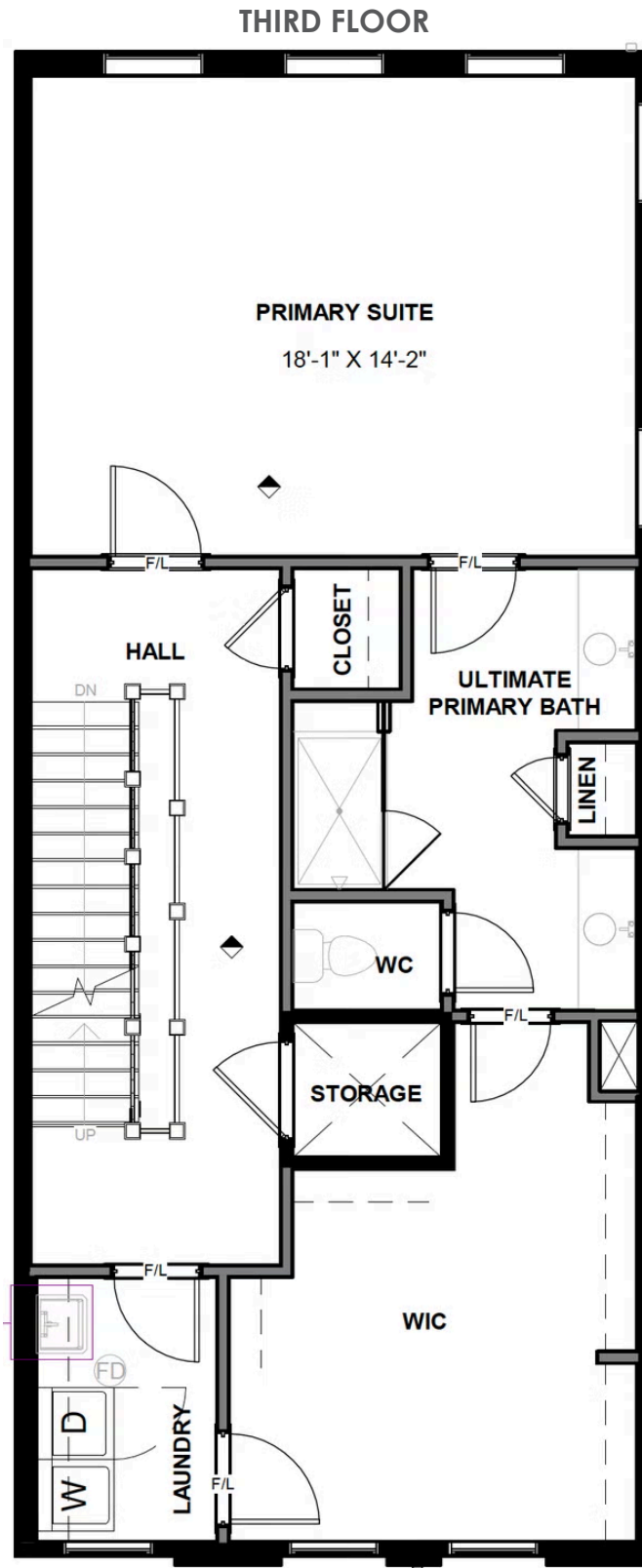

eagleofva.com

FOURTH FLOOR

