





12560 North Readers Lane eagle

AT READERS BRANCH SINGLE FAMILY HOMES

-  3 Bedrooms
-  2.0 Bathrooms
-  2106 Square Feet
-  2 Car Garage

\$659,990

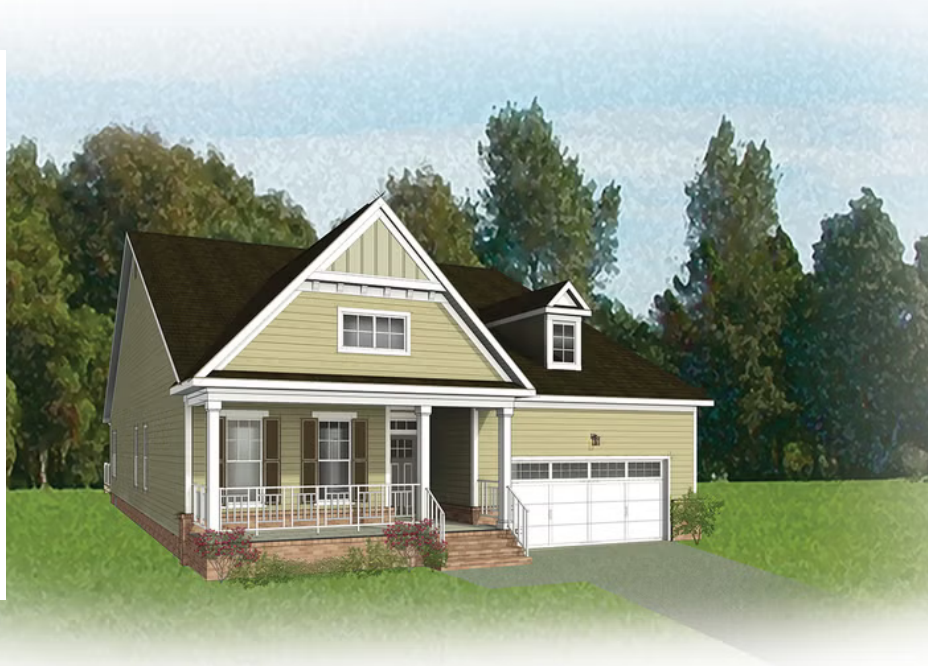

Taking single-level living to the next level of style, the Corvallis offers 3 bedrooms, 2 full baths, a 2-car garage, and over 2,000 square feet of space. You'll feel right at home in the expansive, easy-flowing design blending both modern kitchen and family room (with fireplace) into a centerpiece for contemporary living. After the day, escape to your primary bedroom oasis, complete with a Serenity primary bath with bench seat in shower and large expanded walk-in closet. Relax out on your screened porch with your morning coffee or wind down in the evening. Two additional bedrooms and a central laundry room complete the plan. Packed with features and built for flexibility, the Corvallis can be personalized to match your lifestyle.

Features of this Home

- Serenity primary bath with bench seat in shower
- Expanded primary closet
- Screen porch
- Pocket door in laundry room
- Fireplace
- Gas plumbing
- HDMI video package

eagleofva.com

12560 North Readers Lane



eagle

AT READERS BRANCH SINGLE FAMILY HOMES

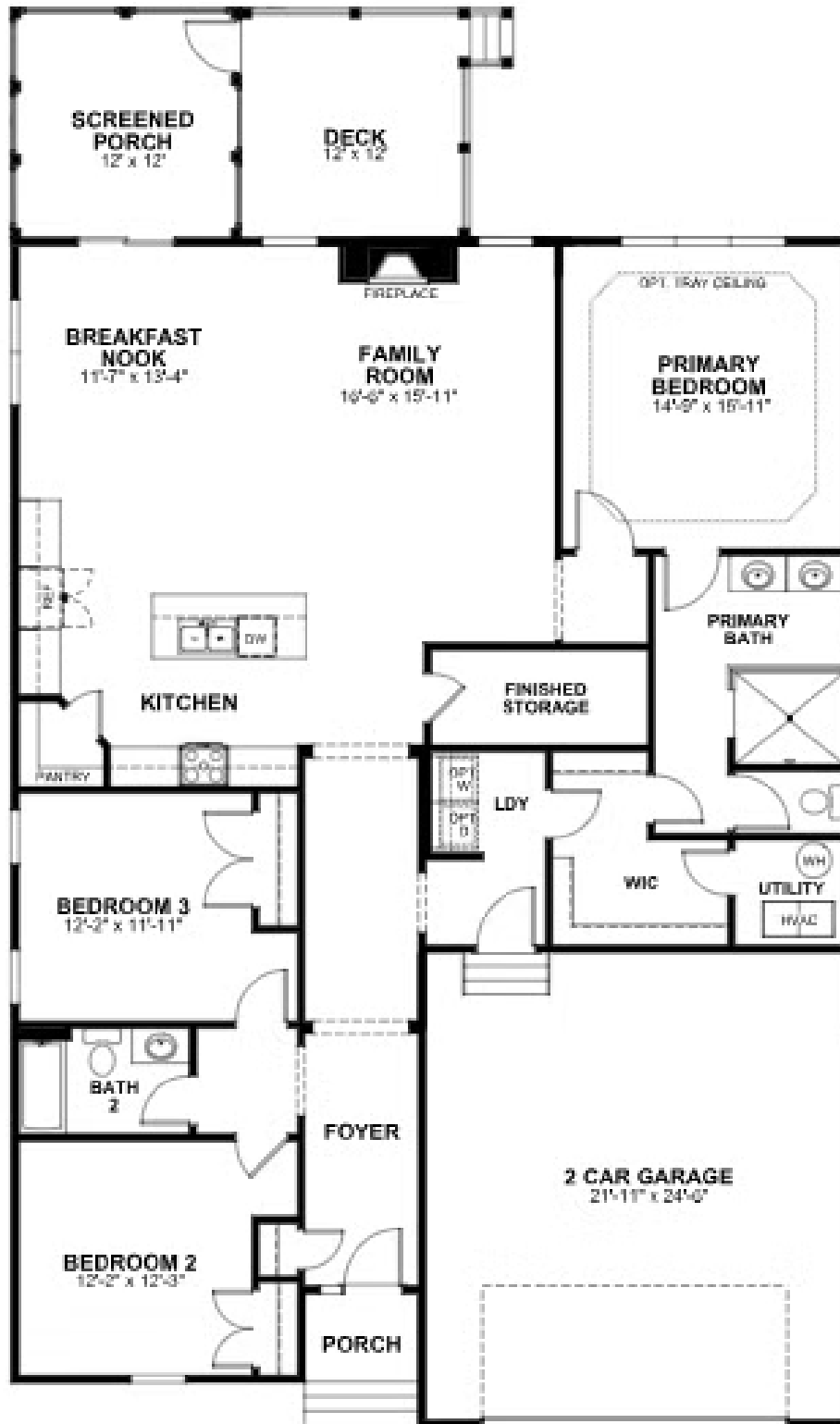

eagleofva.com

This information is deemed reliable but not guaranteed. All details, dimensions, square footage, illustrations and pricing are approximate and may vary from actual plans and specifications. Contact an Eagle Sales Consultant for details. Current information as of 14th May 2024